



HMD 27 | HME 27 HMDC 27

Quick Guide
Kurzanleitung
Guide rapide
Guía rápida
Guía de inicio rápido
Guia rápido
Beknopte handleiding
Krótka instrukcja obsługi
Snabbguide

Kort vejledning
Pikaohje
Γρήγορος οδηγός
Kısa Kılavuz
Краткая инструкция
快速指南
快速使用指南
クイックガイド
퀵 가이드

SENNHEISER



www.sennheiser.com/download

Sennheiser electronic SE & Co. KG

Am Labor 1, 30900 Wedemark, Germany
www.sennheiser.com

Printed in Germany, Publ. 03/24, 402200/A01

In the box

HMD 27



HME 27



HMDC 27



OR

OR

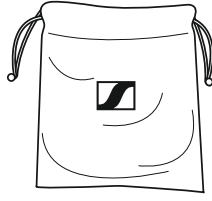

+



+



+



Connecting the headset



T10

Connect the cable to the headset and your system.

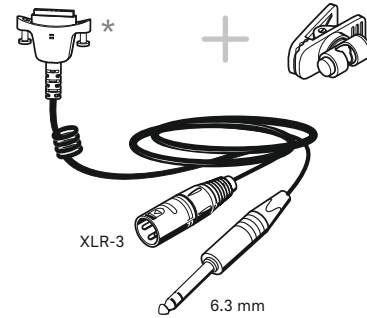

Set your audio source to a medium level.



*Cable not included: Cables with different connectors available - see page 2

Activating NoiseGard™

HMDC 27

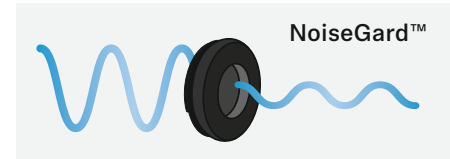
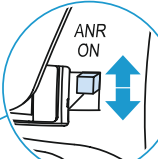
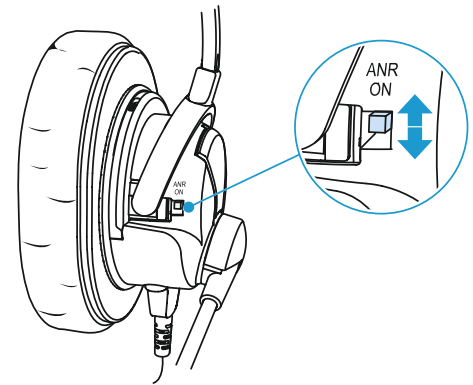

NoiseGard™

Wearing the headset

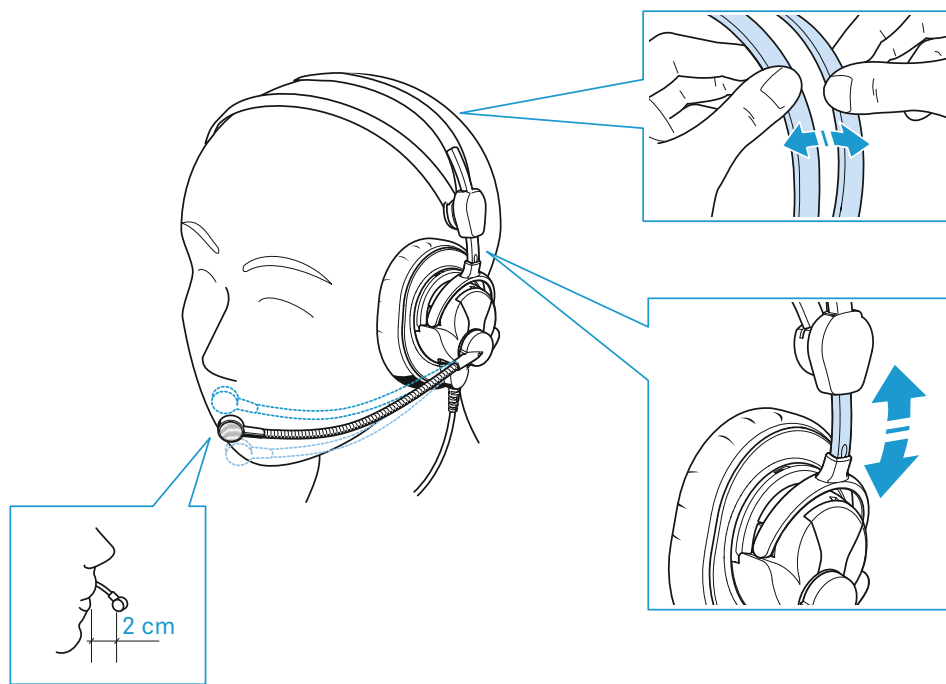
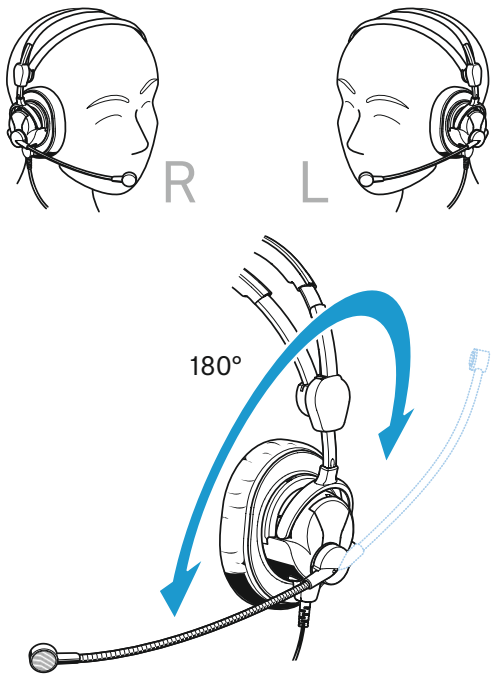

Single-sided listening

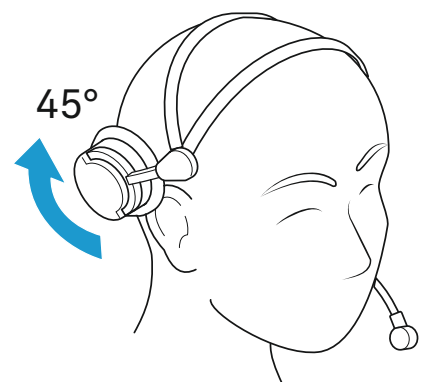

Switching ActiveGard™

HME 27
HMD 27

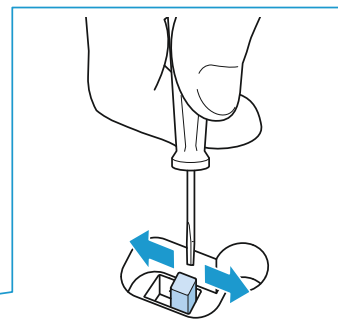
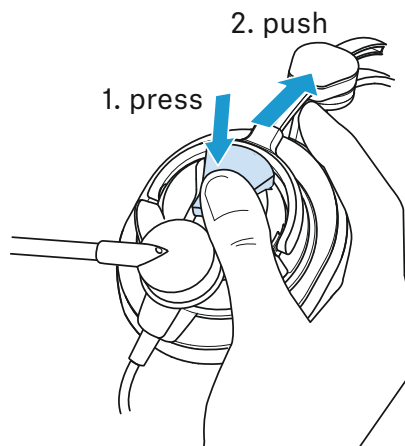
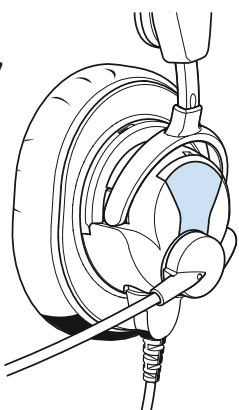

ActiveGard™

- On: 95 dB
- On: 110 dB*
- Off

HMDC 27

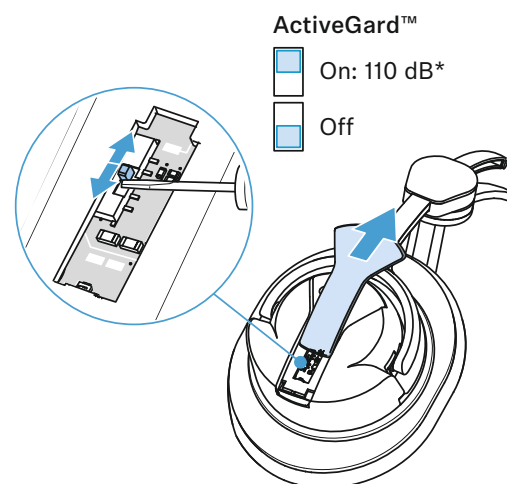

ActiveGard™

- On: 110 dB*
- Off

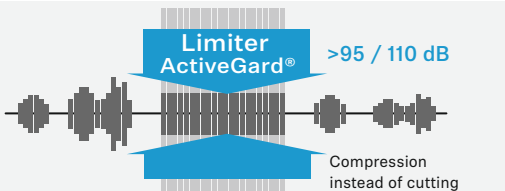

*Factory preset: 110 dB

Replacing the headband

Wearing with large headband padding

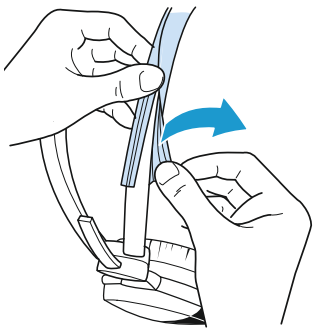

1 Remove both small headbands.

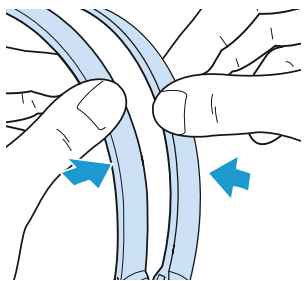

2 Collapse the split headband.

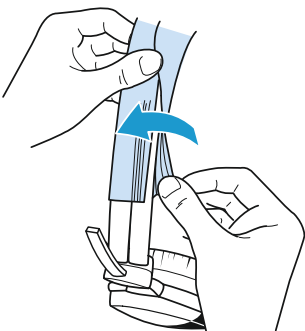

3 Mount the large headband padding.

Wearing with small headbands

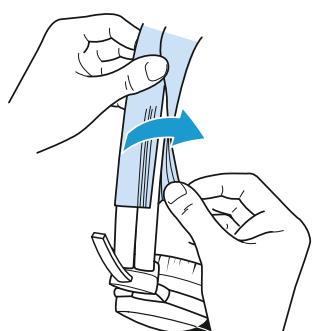

1 Peel off the large headband padding.

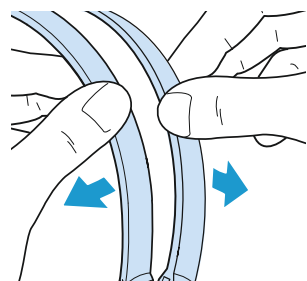

2 Pull the headband carefully apart.

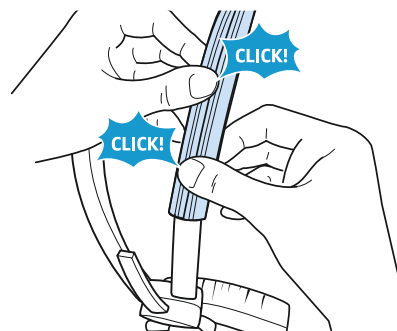

2 Mount the small headbands.

Using accessories

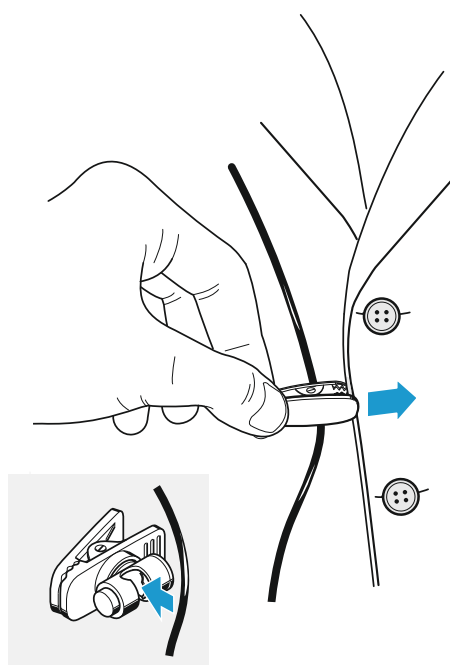

Windshield

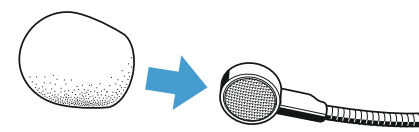

- 10 dB

Replacing the ear pads

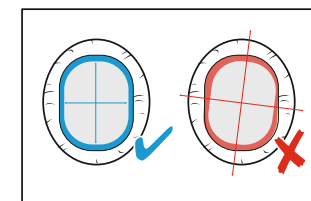
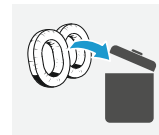
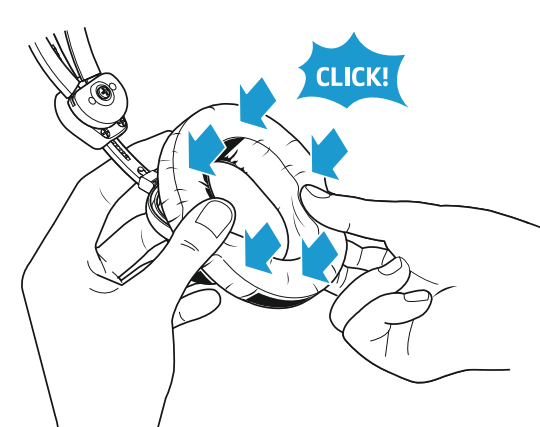
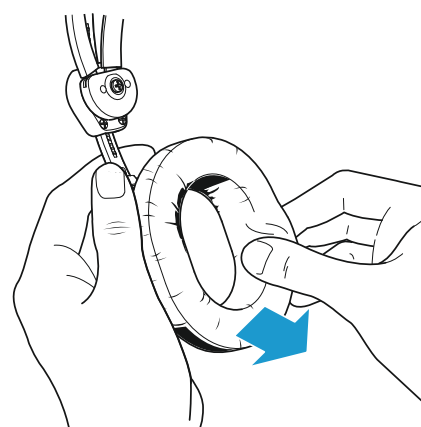

Specifications

Headphone	HME 27	HMD 27	HMDC 27
Transducer principle		dynamic, closed	
Ear coupling		circum-aural	
Frequency response		4 Hz - 21,000 Hz	
Impedance	64 Ω		130 Ω
Characteristic SPL	102 dB SPL @ 1 kHz, 1mW		105 dB SPL @ 1 kHz, 1mW
ActiveGard Level	95 dB SPL/110 dB SPL @1 kHz		110 dB SPL @ 1kHz
Max SPL (ActiveGard off)	125 dB SPL		
THD	< 0.1% @ 1 kHz, 100 dB SPL		
Contact pressure	3.6 N		

Microphone	BKE 10-4	BMD 434	
Type	pre-polarized condenser	dynamic	
Transducer principle	pre-polarized condenser	dynamic	
Frequency response	40 Hz - 20,000 Hz	40 Hz - 18,000 Hz	
Directivity	cardioid	hyper cardioid	
Output voltage	16 mV/Pa @ 1 kHz	0.5 mV/Pa @ 1 kHz	
Impedance	-	300 Ω	
Interface	phantom powered 48 V	balanced	phantom powered 48 V

General Data		
Ambient temperature	Operation: -15 °C to +55 °C	
	Storage: -40 °C to +70 °C	
Weight without cable	approx. 240 g	approx. 250 g

Cleaning

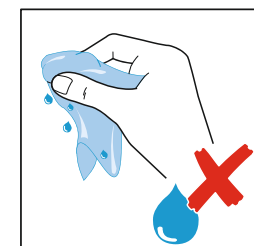

Available cables

CABLE-II-X3K1

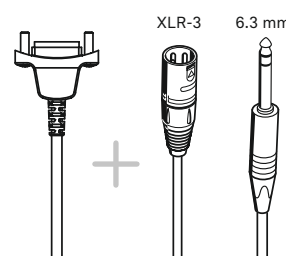

CABLE II-X4F

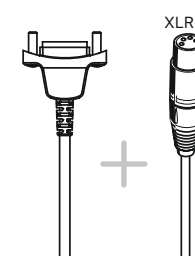

CABLE II-X5

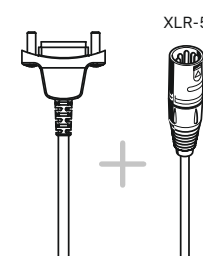

CABLE II-6

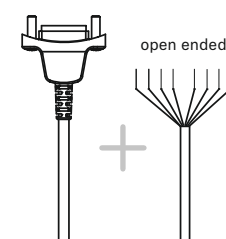

CABLE II-8

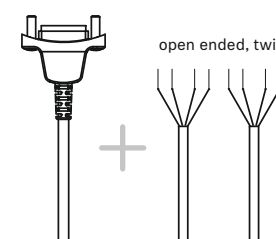

Pin assignment

- 1 Audio Hi left
- 2 Audio Hi right
- 3 Audio Lo left
- 4 Audio Lo right
- 5 not assigned
- 6 Microphone Hi
- 7 Microphone Lo
- 8 Screen